

FLOOD-LINE CERTIFICATION:
 I HEREWITH CERTIFY THAT IN TERMS OF THE REQUIREMENTS OF SECTION 144 OF THE NATIONAL WATER ACT, 1998 (ACT 36 OF 1998) THE PROPOSED LAND DEVELOPMENT AREA IS AFFECTED BY A FLOOD LINE WITH AN EXPECTED FREQUENCY OF RECURRENCE OF 1:100 YEARS AS INDICATED ON PLAN NO. LDA/RAPIDS EST/02

PROFESSIONAL ENGINEER _____ DATE _____
 (PR ENG REG NO: _____)

LAND-USE TABLE

ZONING	PORTION NUMBER(S)	NO. OF PORTIONS	AREA OF PORTIONS (ha)	%	PERMITTED LAND-USE
Residential 1	1-35	35	4,000	1,5	Private Lodges / Resort Dwellings
Special	36	1	0,5247	0,2	Commercial Lodge
Special	Remainder of Portion 19 (De Suikerboskopp 381-JS)	1	44,9765	16,7	Private open space, manager's residences, staff housing, hiking / horse trails, hiking huts, recreation, sports, fishing, agriculture, conservation, game farming, access control & private access road.
	Remainder of Portion 16 (Wetvreden 386-JS)	1	220,1353	81,6	
TOTAL		43	269,6365	100,0	

PROJECT:
 PROPOSED PRIVATE RESORT & SUBDIVISION OF PORTION 16 OF THE FARM WETVREDEN 386 JS, & PORTION 19 OF THE FARM DE SUIKERBOSKOP 381 JS

RAPIDS COUNTRY ESTATE

LOCALITY PLAN:

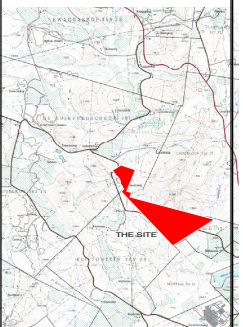

GENERAL NOTES:

1. All distances in metres.
2. All distances and areas are approximate, subject to final survey.
3. Contour map supplied by Fotogrammetria
4. Figure ABC, middle of river DUTCHMAN, middle of river M represents proposed land development area.

APPROVED:

BY
MPUMALANGA DEVELOPMENT TRIBUNAL

ON _____ 2005

SIGNATURE _____

CAPACITY _____

LOCAL AUTHORITY: APPLICANT:

EMAMAZENI MUNICIPALITY PO BOX 17 BELFAST 1100	WETVREDEN FAMILIE TRUST 59 EXPERIENTIAL TECHNOLOGIES P O BOX 3284 GLENSTANTIA 6001
--------------------------------------------------------	---------------------------------------------------------------------------------------------------

J PAUL VAN WYK
 TOWN & REGIONAL PLANNERS
 DEVELOPMENT ECONOMISTS

POSBUS 11522 HATFIELD 0028	P.O. BOX 11522 HATFIELD 0028
TEL: (012) 361-0217 FAX: (012) 361-2126 SEL: (082) 893-7370	TEL: (012) 361-0217 FAX: (012) 361-2126 CELL: (082) 893-7370

DRAWN PWW (OLA)	FIGURE 3
SCALE 1:7500	DATE 2007/06/13
DESIGN J.P. van Wyk	CONTOUR INT. LDA/RAPIDS EST/04v
	PLAN NUMBER LDA/RAPIDS EST/04v

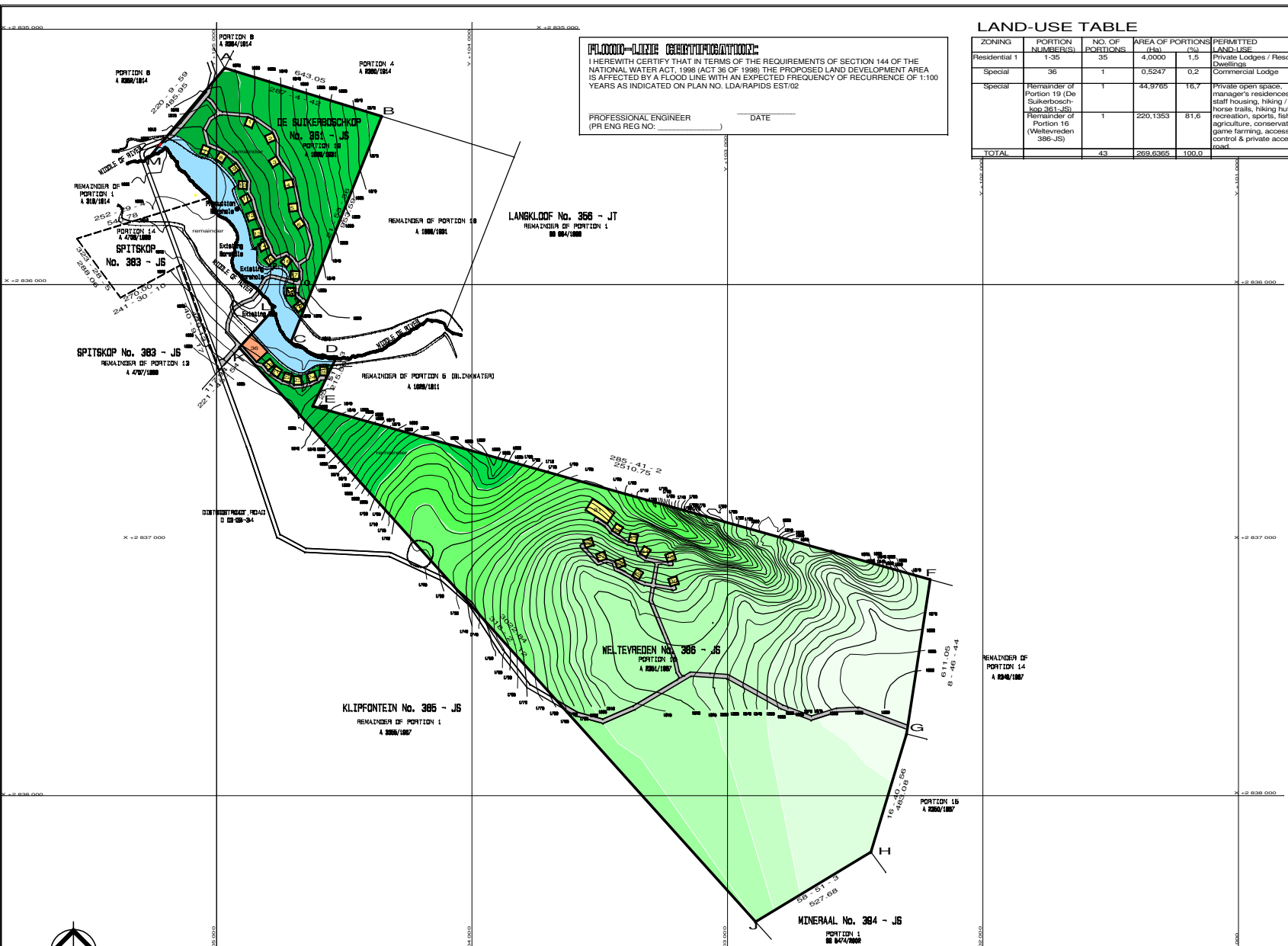

PROPOSED ERF LAYOUT

